



GAI-TRONICS® CORPORATION  
A HUBBELL COMPANY

# Model 295W Clean Phone™ Telephone

## General Information

This data sheet applies to the GAI-Tronics Model 295W Wall-Mount Clean Phone™ Telephone, which is designed for the exacting requirements of clean rooms. It is constructed of stainless steel with a completely smooth polyester front panel that will not trap particulate matter. Calls are made by pressing one of the two auto-dial buttons or by using the fully functional keypad. The Flash button allows the phone to use the features of a PBX system. The oversized buttons allow for operation with gloved hands.

The phone's two auto-dial buttons to store frequently dialed telephone numbers and a programmable activation/deactivation of the Auto-answer feature. When activated, this feature determines how many rings must elapse before auto-answering. The auto-answer feature allows the telephone to go off-hook automatically so technicians do not have to leave their work stations to answer the telephone.

A light under the ON portion of the ON/OFF button is activated to indicate if the telephone is off-hook. The Model 295W can be programmed locally or remotely using another DTMF telephone. The programming mode, whether local or remote, is entered through a series of button presses. The Model 295W can be programmed for touch-tone (DTMF) or pulse dialing.

The Model 295W is powered from a 48 V dc @ 250 mA power supply, which should be NRTL listed per UL specification UL 1012 or equivalent. If powered through the black and yellow "spare pair" in the telephone cable, the power to these wires must be limited to UL Level C power (1 ampere maximum at 48 V dc).

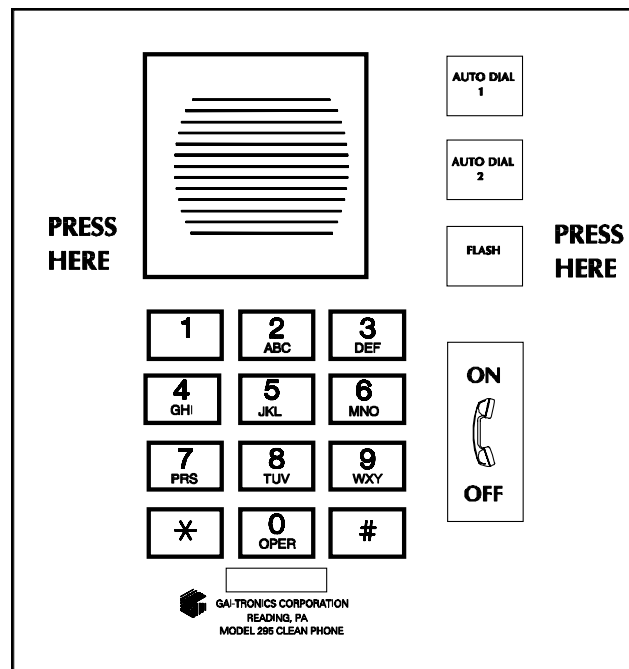

Figure 1. Front panel with pressure points shown

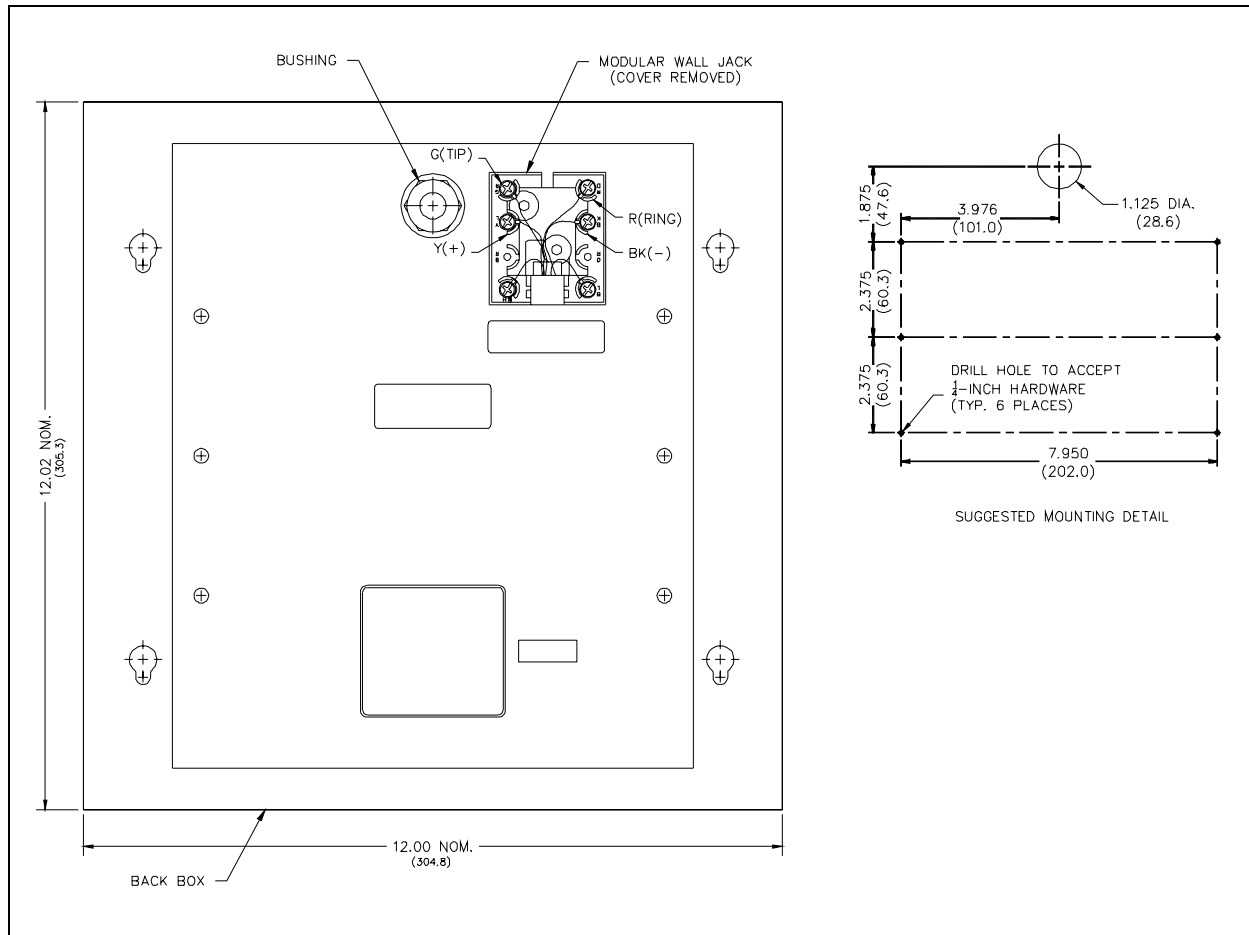

Figure 2. Model 295W Modular Jack and Mounting Details

## Specifications

Power input .....	48 V dc, 250 mA
USOC .....	RJ11C
Signaling .....	DTMF or pulse (programmable)
FCC Registration Number .....	ADGUSA-60747-MT-E
Ringer Equivalence Number (REN).....	0.4B
Speaker output.....	85 dBA spl @ 1 meter, full volume (max. speech level)
Operating temperature .....	-20° C to +60° C (-4° F to +140° F)
Construction .....	Front panel: tactile, polyester membrane panel Mounting bracket: 16-gauge stainless steel
Dimensions .....	Front panel: 12 W × 12 H inches (304.8 × 304.8 mm) Back enclosure: 12 W × 12 H × 2.06 D inches (304.8 × 304.8 × 52.3 mm)
Weight.....	5.25 lbs